



RK SECURITY SOLUTION

SECURITY SYSTEMS AND HIGH MASTPOLE LIGHTING SOLUTION

Head Office In Delhi : - D-1/40 jail road Mandoli extension Delhi 93
 manufacturing unit :-4/2 jhandapur main road, Sahibabad Industrial Area Site 4, Ghaziabad, Uttar Pradesh 201010
 raj.technicalhead@gmail.com Website: - www.rksecuritysolution.com

About Us

We, **R. K. Security Solutions** are continually striving to help society in the tasks of safety, security and surveillance. Our firm is a leading **manufacturer** and **trader** of **Automatic Boom Barrier, Flap Barrier, Full Height Turnstile, Garage System, Road Blocker, Sensor Sliding Door, Silt Barrier** and **Sliding Gate Operator**. Additionally, we are offering **Swing Gate Operator, Traffic Light, Under Vehicle Surveillance System, Tripod Turnstile**, etc. Apart from that we are also providing **repair, maintenance & installation service** for the range of products. Keeping in the mind technological advancements and challenges for safety & surveillance, our products are developed by smart engineers. These are made and offered in several standard models, sizes, designs and specifications to fit into the requirements & budget of a large number of clients. Our **barriers** are well appreciated in the market for their **resistance to abrasion, rigid construction, ability to withstand diverse weather conditions and durability**. Clients widely appreciate our **under vehicle surveillance systems, traffic lights and security items** owing to their **brilliant performance, ergonomic designs and reliability**.

Our firm is meeting known in the market as a most trustworthy **service provider**, rendering various solutions that help in having a safer place. Some of the services that are provided by us to customers are of **Executive Protection; Integration of Automated/ Manual Systems, Development of Management Systems, Procedures and Standing Orders; Fire & Safety Awareness For Customers, Front Office Management and Parking Area Management**.

Mission & Vision

We are working with the mission to provide maximum benefit to customers through our security and allied services. For this, we regularly update our resourceful skills and keep experts updated with the aspects of service maintenance. Our vision statement includes to attain optimum contentment level of clients via our competent, worthwhile, steadfast and principled services. For attaining our vision, we focus on:

- Regularly upgrading services
- Providing challenging assignments to our professionals to sharpen their skills and giving them chance to make optimum utilization of their talents

Our firm also give stress on:

- Look forward to and meet up challenging customers
- Building long-term relationship with our customers
- Optimized utilization of latest technology

Our Core Values

- Maintaining excellence by regularly bringing improvements
- Highest standards of honesty & integrity
- Valuing customers and ourselves

Quality Assurance

we have maintained our USP in the superior quality of our conglomerate. Each product of our firm is manufactured from quality norms. Our quality controlling team keeps an eye on all the stages of production to rule out the chances of occurring defects. This team also examine all the self-developed as well as sourced products such as *Automatic Boom Barrier, Chiller Plant, Full Height Turnstile, Garage System, Sensor Sliding Door, Spike Barriers/Tyre Killer, Traffic Light, Tripod Turnstile* etc. on various parameters to assure flawlessness, prior to dispatch. Our range is quality scrutinized on the grounds of its resistance to diverse weather conditions, durability, design accuracy, performance, construction etc.

What We Offer?

We are catering to the requirements of market by **manufacturing** and **trading** following products:

- **Automatic Bollards**
- **Automatic Boom Barrier**
- **Flap Barrier**
- **Full Height Turnstile**
- **Garage System**
- **Parking Management**
- **Road Blocker**
- **Security Items**
- **Sensor Sliding Door**
- **Silt Barrier**
- **Sliding Gate Operator**
- **Spike Barriers/Tyre Killer**
- **Stage Auditorium**
- **Swing Gate Operator**
- **Traffic Light**
- **Tripod Turnstile**
- **High Mast Lighting Pole**
- **Chiller Plant**

In addition, we also provide **repair, maintenance & installation services for the range of products.**

Services offered

our firm, as a dependable **service provider**, is rendering impressive solutions for the following:

- **Guarding Apartments, Layouts, Commercial Premises and Manufacturing Units**
- **Executive Protection**
- **Security Management Systems**
- **Integration of Automated/ Manual Systems**
- **Development of Management Systems, Procedures and Standing Orders**
- **Fire & Safety Awareness For Customers**
- **Front Office Management**
- **Parking Area Management**

Our Talented Team

A team of talented and highly sincere professionals backs us in all our endeavors and ultimately meeting all the requirements of customers. Our team possesses three D's qualities which include Dedication, Discipline and Devotion due to which we are making record of accomplishing all the tasks with perfection. All experts of our firm keep themselves updated with the advancements of safety & security products industry so as to come up with commendable solutions. Further, our professionals work in complete harmony with one another to take firm to the heights of success.

Clientele

- AIMIL Pharmaceuticals (India) Ltd.
- Ansal Housing & Construction Limited
- Apex Network
- Arcee Trading Corporation
- Char Dham Temple, Sikkim
- Eskay Yartex Pvt. Ltd.
- Eureka Exim Pvt. Ltd.
- G.D. ITL Towers
- Globetel
- Golden Temple
- Guru Gram Public School
- Hamdard (Wakf) Laboratories
- DRDO
- Indian army
- ITL
- ITL Infotech Ltd.
- ITL Public School
- NSCC
- SAIL
- Shriram
- Welcome 5 Star Hotel
- State Bank of India
- Surya Bulbs
- ORDNANCE FACTORY ITARSI
- AUDI





MRP 120000/-

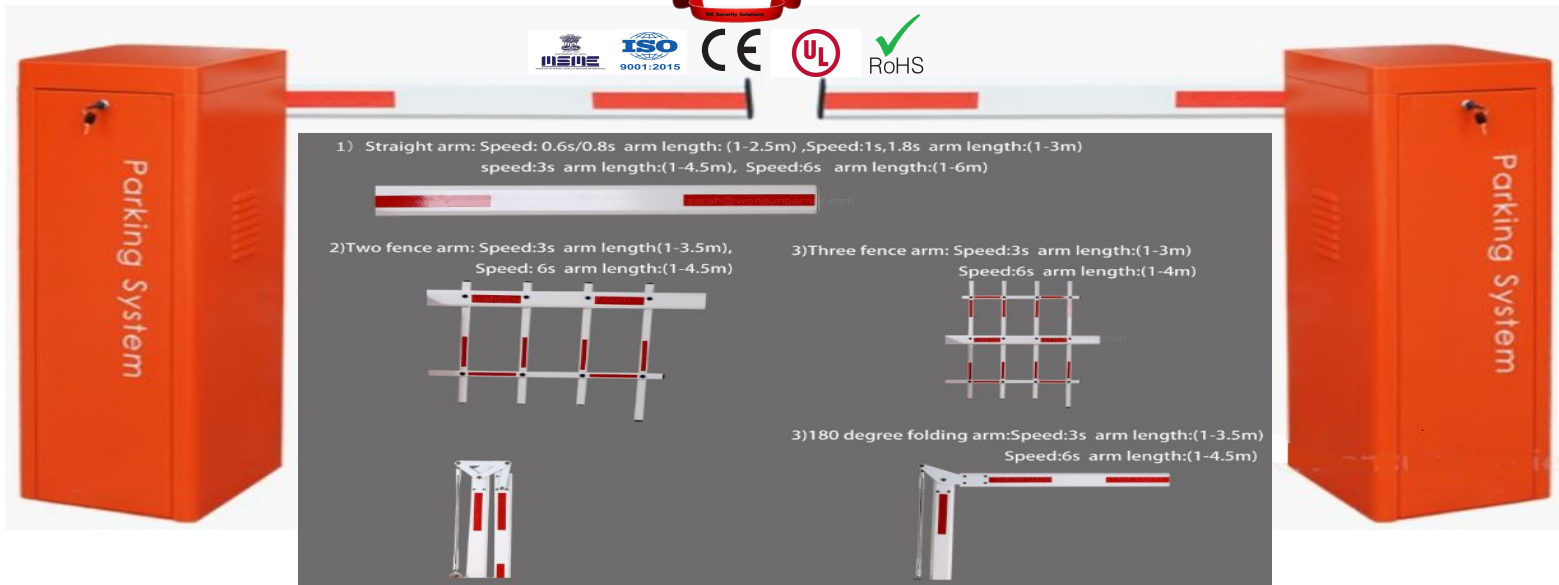

RKSS's Patriot Series Barriers are the ideal choice for heavy duty operation. When the requirement is a combination of maintenance free operation and aesthetic looks, Patriot barriers fit in perfectly. Made indigenously and designed with technical collaboration from Singapore, the Patriot barriers have the following features:

FEATURES & BENEFITS:

100% DUTY CYCLE OPERATION WITH 5 MILLION MTBF:

Free-maintenance torque motor ensures 100% duty cycle operation with 5 million MTBF. The heavy duty Gear Drive Motor is environment friendly, energy-saving, and maintenance-free. No electric shock or overheating while working, it protects the controller and prolongs its lifetime.

EASY INSTALLATION AND MAINTENANCE REDUCES YOUR LABOR COST :

Simple structure and double limit switch design ensures easy installation and maintenance and also reduces maintenance cost.

MANUAL OPTION IN CASE OF POWER FAILURE:

If power is suddenly switched off while the boom is closing, the barrier is equipped with a manual knob which enables the operator to manually open or close the Barrier.

HEAVY-DUTY, WEATHER-PROOF AND SIMPLE-DESIGN HOUSING:

The housing adopts 2mm precise machining cold-rolled plate and static electricity sprayed anti-UV surface which does not fade over time in. It conforms to IP54 dustproof and waterproof standards. It is simple in design and aesthetically decorates your premises.

SINE LEVER DRIVE MECHANISM ENSURES SMOOTH LANDING OF BOOM WITHOUT SHAKING :

The patent pending precise casting sine lever drive mechanism enables the boom arm to move from slow to fast when it starts, and fast to slow when it stops. This will effectively reduce the shaking of the boom arm and reduce the burden of the electrical motor, in the way the lifetime of the motor and mechanical components is prolonged.

"PROUDLY MADE IN INDIA "



Size	350*270*935mm
Rating Voltage	AC 220/110V $\pm 10\%$, 50/60Hz
Motor Power	80w
Speed Option	1.8s; 3s; 6s
Material	1.5mm galvanized plate or cold roll plate with epoxy paint
Weight	55 KG
Operation Testing	More than 5 million times
Arm Option	Straight arm, 1-6 m for option, 45*80mm or 45*100mm Folding arm, 1-4.5 m for option, 90 degree or 180 degree Fence arm, 1-5m for option, two fence or three fence
Working Temperature	-45°C — +75°C
Remote Control Distance	50-100m
Package	Packing size: 1040*352*470mm, standard export carton case Inside with PE foam for collision protection
Application	Suitable for Highway, toll station, open-parking ground, underground parking, community, shopping center

Functions&Features:

- 1) Machine core with tension spring, effectively avoids the accidents caused by spring breaking
- 2) Die-casting aluminum alloy motor, precision and good at thermal radiating
- 3) Double safety limit switches (photocell electrical limit switch/motor memory sensor)
- 4) Arm swing out
- 5) Support the INFRARED PHTOCELL for anti-bumping function (optional)
- 6) Support the external and internal VEHICLE LOOP DETECTOR (optional)
- 7) Traffic light interface
- 8) Wire control (switch signal)/ Remote control (418MHZ)
- 9) RS485 communication module (optional)

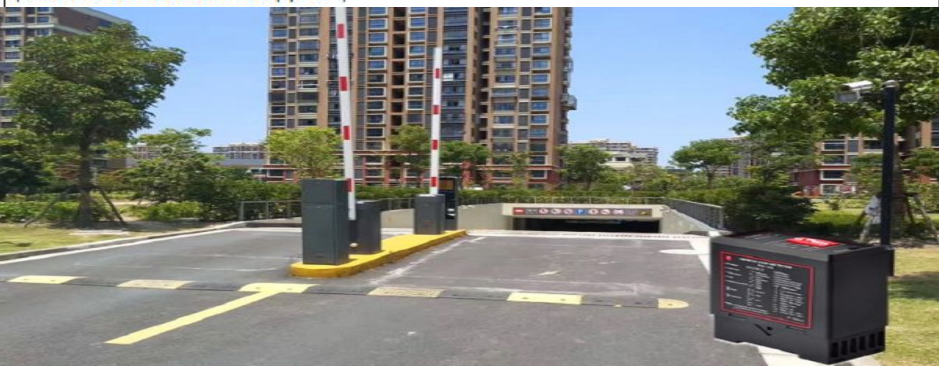
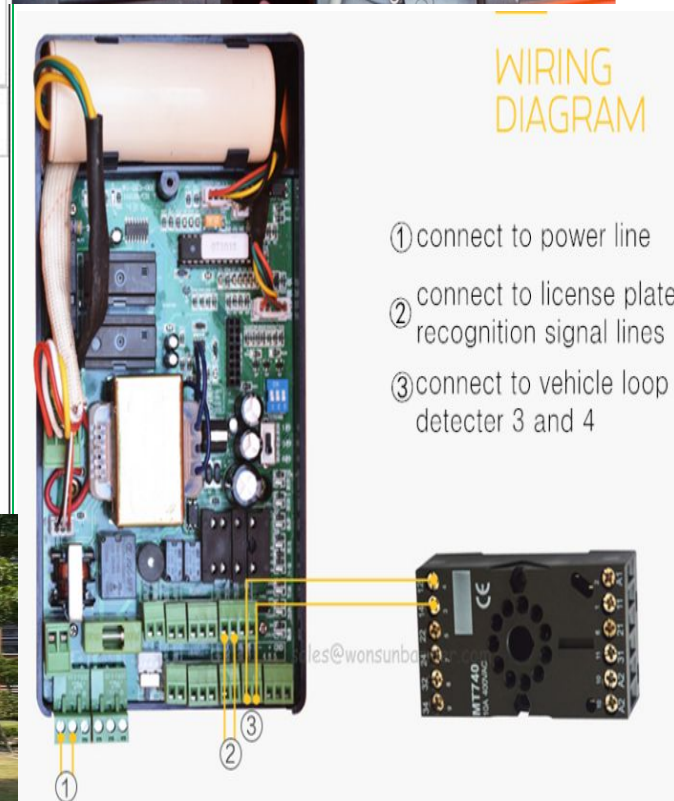

R.K.SECURITY SOLUTION

<http://rksecuritysolution.com>
<http://ofergates.com/en/>



"PROUDLY MADE IN INDIA"



Rk Security Solution STAINLESSSTEELFLAP BARRIER IS A USER FRIENDLY ACCESS BARRIER DEVELOPED FOR THE EFFICIENT CONTROL OF PEDESTRIAN MOVEMENT ACCORDING TO THE DEMANDING INDIAN CONDITIONS. THE BARRIERS CAN BE MOUNTED WITH DISPLAY, PASSAGE COUNTER, CARD READER, TOKEN OPERATION, TRAFFIC LIGHTS, COMMAND CONSOLE, ALARM SYSTEM, WHICH CAN ALL BE INTERFACED WITH A PC THROUGH RS232,RS485 TCP-IP (OPTIONAL)LINE. THE FLAP BARRIER PROVIDES A FAIL-SAFE SAFETY SOLUTION IN CASE OF EMERGENCY OR POWER FAILURE, PROVIDING EGRESS WITH THE FLAPS RETRACTING INTO THE MAIN PANEL.

FEATURES & BENEFITS

- Can be integrated with all ID Cards, IC Cards, Bar code or magnetic cards
- A passage indicator continuous LED shows to the pedestrian the right access points, and allows pedestrians correct and smooth passage.
- A combination of 06 pairs of infrared sensors for protection of pedestrian access.
- Double anti-clipping function, (Photocell and Mechanical).
- Auto re-set function, if no passing identified even after card being read, the system will reset automatically and one is prohibited to pass until their second card reading is attempted.
- The barrier can be set to close immediately or adjusted for a delay of 1-60s after a valid card reading.



- **OPERATING MODES:**

- o Single passage in the set direction.
- o Bi-directional single passage.
- o Free passage in the set direction.
- o Always free or locked.

- **MATERIALS:**

- o Housing: Made with Stainless steel AISI 304.
- o Barrier Swings: Plastic plate, toughened glass.
- o Lid (Optional): stainless steel or artificial stone (black/brown)

- **COLORS & FINISHES:**

- o Dark grey color high quality powder coating plus lacquered finish
- o Sandpaper powder coating with pearl mica effect

- **MECHANISM:**

- o Heavy duty design for 24 hours continuous application.
- o Heavy duty pull type.
- o Indoor and Outdoor application (Canopy solicited)
- o High durability with industrial parts.
- o Smooth, Noiseless and Shockless operation.

- **COMMUNICATION:**

- o Dry contact relay with 12 volt or 24 volt plus.
- o RS 485 or TCP-IP (Optional) communication with computer.

- **MOTOR**

- o Tested for Three Million operations and above.
- o Overheat and overload protection for motor

MODEL NO.	RK.F3
PASSAGE WIDTH	550MM
POWER SUPPLY	220-240 V(AC)
OPERATION VOLTAGE	24 V(DC)
MAX POWER CONSUMPTION	60W
FREQUENCY	50-60 HZ
PROTECTION LEVEL	IP 44
WORKING TEMPERATURE	-25 TO +70 0C
ELECTRO-MAGNETIC DRIVE	DC
DIMENSIONS INCLUDING BARS	1400*280*980 MM
NET WEIGHT INCLUDING BARS	87 KG
THROUGHPUT RATE	40 P/M
DUTY CYCLE	100%



RK SECURITY SOLUTION

<http://rksecuritysolution.com>

<http://ofergates.com/en/>

"PROUDLY MADE IN ISRAEL"



The RKSS™ Traffic Spike Barrier System is designed for use in high security as well as high traffic applications. The Traffic Spike barrier is a simple to install highly effective vehicle control barrier, ideally suited for approach entrances to banks, military installations, airports, docks, cash collection depots government offices, etc.

The RKSS™ Traffic Spike teeth retract below ground level when a signal is received from the push button or integrated access control unit providing safe access or authorized vehicles. When the vehicle has passed, the teeth return to the active position, ensuring total protection from unauthorized vehicle intrusion.

These barriers may be used with any type of access control system. We recommend that the Traffic Spike is used in conjunction with a vehicle barrier gate to act as a safety device to prevent the barrier operating when an authorized vehicle is stationary over the teeth.

Colour & Body	: Yellow and Black, MS Flats of 25mm Thickness
Height of Spike	: Above Block 90 – 110 mm
Spike Dimensions	: 165 * 25 mm (OD)
Width of the block	: 600mm
Length of the Block	: 3000 – 6000 mm
Thickness of Strip	: 65/25mm
Spike to Spike Distance	: 100mm
Opening & Closing Time	: 3 to 5 secs
Housing	: M.S
Installation	: depth 135mm
Vehicle Load	: 25ton
Safety Devices	: Remote Control, Smart Card Reader, Optical Beam Sensor, Loop Detectors, Biometric Devices etc.(Optional)
Application	: High Security areas, Heavy Industry, Oil Refineries, Airports, Embassies, Military Base, Power Plants etc.

Activate Windows

For RK SECURITY SOLUTION

RK Security

Prod



inferior to none, superior to many

RK SECURITY SOLUTION

S4 Retractable Bollard

RKSS presents India's first crash simulated and indigenously designed bollard. Our bollards have been tested by India's premier R&D institute, ARAI, Pune wherein the bollard was hit at 48km/h (30mph) by a fully laden 6.8kg truck and on each occasion, simulated a complete dead stop of the vehicle.

The bollard has been manufactured keeping in mind the corrosive nature of the tropical Indian climate. All parts of bollards are hot dip galvanised to prevent corrosion and smooth functioning even when submerged in water. To give a fine balance between aesthetics and security, all bollards come with an aesthetically pleasing stainless steel sleeve and Stainless Steel top plate which easily merges with the environment.

Our bollards are fast and are ideal for infrastructure requiring a high level of protection from forced impact, have least distance to the point of impact and requires continuous operation. With Spare kit a part of our standard supply, after sales service is always our priority.

SAFETY :

- Safety against vehicle: Loop Detector
- Safety against human traffic: Photo Sensor

CONTROL UNIT :

Plc based control unit which can be tailor made to your use and can be integrated to all access control devices.



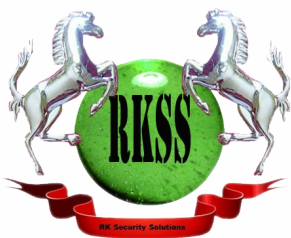

RK SECURITY SOLUTION

inferior to none, superior to many

SPECIFICATIONS

SL. NO.	DESCRIPTION	SPECIFICATIONS
1	MODEL NO.	S4
2	DRIVE UNIT	HYDRAULIC (S4-H), PNEUMATIC (S4-P)
3	CYLINDER DIAMETER	220 MM
4	CYLINDER LENGTH	700 MM
5	RATING	K4/PAS 68/IWA14:2013 (6.8 TON TRUCK IMPACTED AT 48 KMPH)
6	CYLINDER MATERIAL	HIGH TENSILE CARBON STEEL
7	RISING TIME (EMERGENCY)	2 SEC.
8	RISING & LOWERING TIME (NORMAL)	3 SEC.
9	HYDRAULIC DRIVE UNIT	420 V (AC), 50 HZ
10	PROTECTION CLASS	IP 67
11	DUTY CYCLE	100%
12	ILLUMINATION	RED LED/ REFLECTIVE BANDS
13	MANUAL LOWERING OPERATIONS	AVAILABLE
14	OPERATING TEMPERATURE	-20 °C TO +60 °C
15	TOTAL WEIGHT	200 KG
16	UNIQUE MECHANISM	IN BUILT TIE ROD MECHANISM

SAFETY PARAMETERS

17	SAFETY AGAINST VEHICLE	LOOP DETECTOR
18	SAFETY AGAINST HUMAN TRAFFIC	PHOTO SENSOR
19	CONTROL UNIT	PLC BASED CONTROL UNIT WITH TAILOR MADE INTEGRATION WITH ALL ACCESS CONTROL DEVICES

RK SECURITY SOLUTION

"PROUDLY MADE IN INDIA"

SECURITY SYSTEMS AND COOLLING SOLUTION CONTRACTOR

OFFICE: - D-1/40 JAIL ROAD MANDOLI EXTN. DELHI 110093

RAJ.TECHCALHEAD@GMAIL.COM, MD@RKSECURITYSOLUTION.COM

WEB.WWW.RKSECURITYSOLUTION.COM



RK SECURITY SOLUTION

Automatic Systems Road Blocker



The new Embassy barricade is a fully enclosed, shallow foundation wedge barricade with covered front and sides. In a fullscale crash test conducted by an independent test lab, the RK- 207s met the criteria for an M50/K12 rating. A 15,000 pound (6800 kg) truck impacting at 50 mph (80 km/h) was stopped dead in its tracks with zero penetration and no foundation damage. It features a small footprint, a new programmable drive system and is extremely serviceable. The new Embassy barricade provides foundation space in which maintenance personnel can easily work. There is space for heaters and sump pumps. Access is available from either the top plate or front. The barricade can also be galvanized. Its small footprint increases the numbers of locations in which it can be used. Available with Delta's new programmable drive system (PDS), the barricade can be electronically powered with an internal limit switch and multiple voltage input. The motor speed control can be programmed to control the barricade so that it operates quickly at first but, at the end of the stroke, slows down so that it does not slam, eliminating wear and noise. Guard operation is with touch screen control via hardwire, networked or fiber optics. Following the crash test the truck was removed along with the front face and the barricade was powered up and found to be fully operational. No foundation damage, slight bend in the top plate, all ready for the next attack.



RKSS.TORIPODWITHITS1.8MMSS304FINISH AND A DIMENSION OF 580MM *310*950MM IS MOST SUITABLE FOR INDUSTRIAL APPLICATIONS WHICH DEMANDS HEAVIEST OF USAGE.ITCAN BE INTEGRATED WITH ANY ACCESS CONTROL SYSTEM AND CAN BE MOUNTED WITH DISPLAY, PASSAGE COUNTER, CARD READER, TOKEN OPERATION, TRAFFIC LIGHTS, COMMAND CONSOLE, AND ALARM SYSTEM. THE TURNSTILE CAN BE INTERFACED WITH A PC. THE UNIQUE DROP ARM FEATURE PROVIDES A FAIL-SAFE SAFETY SOLUTION IN CASE OF EMERGENCY OR POWER FAILURE, PROVIDING EGRESS IN CASE OF CRISIS EVACUATIONS.

FEATURES & BENEFITS

• CONTROLLER:

Semi auto mode: After reading card the passenger pushes the arm by hand until he goes through the barriers and the arm arrives in home position

Automatic reset of barrier arms after each passage

Cable or wireless remote control panel key to override control for emergency situations to provide free passage.

• OPERATING MODES:

- o Single passage in the set direction
- o Bi-directional single passage
- o Free passage in the set direction
- o Always free or locked

• MECHANISM:

- o Heavy duty design for 24 hours continuous application
- o Indoor and outdoor application
- o High durability with industrial parts
- o All the running is quiet without any noise and shock

• COMMUNICATION

- o Dry contact relay with 12 volt or 24 volt plus
- o Rs 485 or TCP-IP communication with computer (optional)

• MOTOR

- o Three million times or above test for motor
- o Overheat and overload dual protection for motor

• MATERIALS:

- o Housing: made in stainless steel AISI 304 with 1.8mm thickness



MODELNO..

Passage width	≤550 mm
Power Supply	220-240 V(ac)
Operation voltage	24 V(dc)
Power consumption	32W
Frequency	50-60 hz
Protection Level	IP 55
Working temperature	-25 to +70 0C
Electro-magnetic drive	DC
Dimensions	580*310*950 mm
Net weight including bars	52 kg
Throughput Rate	30-40 p/m
Duty Cycle	100%

RKSS.T2

R.K.SECURITY SOLUTION

<http://rksecuritysolution.com>
<http://ofergates.com/en/>

"PROUDLY MADE IN ISRAEL"



APPROVED



Security Access

Full Height Turnstiles

RK SECURITY SOLUTION



RKSS



RKSS

RKSS

Versatile turnstiles for indoor and outdoor security

Our full height turnstile product range consists of several models that all offer excellent security control and can be installed indoors or outdoors depending on their type. Our full height security turnstiles, suitable for controlling unsupervised areas, are available in a wide range of custom widths, finishes and configurations to suit almost all buildings and environments.

A wide range of models from which to choose

Our full height turnstiles are available in both a 120°, 3-arm configuration or 90°, 4-arm configuration. The 3-arm models offer users more space and comfort, while the 4-arm models minimize the possibility of piggybacking by restricting the user to a smaller segment.

Single or tandem versions are available on most models. Optional side gates can be used to provide access for wheelchairs, bicycles or handcarts.



Your **Security.** Our **Solution.**

WWW.RKSECURITYSOLUTION.COM



RK SECURITY SOLUTION

Datasheet For Double Traffic Light 4"



SPECIFICATIONS:

- CRCA Sheet Metal Body weather proof with Back Mounting Clamps
- Black powder coated
- Lens Dia: 4"
- Sun Vizor provided for better visibility, more than 200m
- High Intensity LED Lamps RED & GREEN
- Individual LED Drivers for Both LED Clusters
- No. of LED 24 each colour
- LED Specs: If= 20mA, 5mm , Water Clear Oval LED
- Power supply Specs:
- Line Regulation/ working voltage : 90 – 260v AC
- Load regulation : 0.01 0.05%
- EMI protected
- Ripple voltage : 40-100mv
- **Working Temperature** : -25 to + 60 deg
- **Life span** 50,000 Hrs
- **Power Consumption: RED <2W**
- **Power Consumption: GREEN <2.5W**
- Efficiency: 87 to 92%



Multizone Door Frame Metal Detector

Model RE-MP-VI

RKSS RE - MP - VI are six zone separate metal detectors in one frame. This coil structure enhance the metal detection process compared to conventional single zone metal detector. Metal location is reliably displayed at each zone . If metal present in more than one zone , all zones with metal are displayed on the geographical Zone Representation provided on the front panel and the zone with the peak metal is displayed on the 8 digit LED display.

Sensitivity of each zone can be set separately to get uniform sensitivity at each zone Microprocessor technology ensure fast & reliable data processing & operation. Metal detection, sensitivity setting, Threshold setting, Zone discrimination. **RE - MP-VI** detects both ferrous & nonferrous metal.

Salient features

- Multi Zone detection (Six zone)
- Door Frame Metal Detector is Microprocessor based
- Keypad provided for all program settings.
- AUTO SET (No initial setting is required)
- Detector is continuously active
- Self test program , system fault indicator provided
- Display of time ,counter , program setting, sensitivity during setting
- Multi-mode counter i.e. IN, OUT, total IN & OUT
- Infra red occupancy sensors.
- Digitally controlled sensitivity, & volume.
- Independent sensitivity setting of each zone.
- Safe for Cardiac Pacemakers(Operating Frequency 10KHz - 20 Khz) & film safe
- Battery backup for memory protection (Optional).

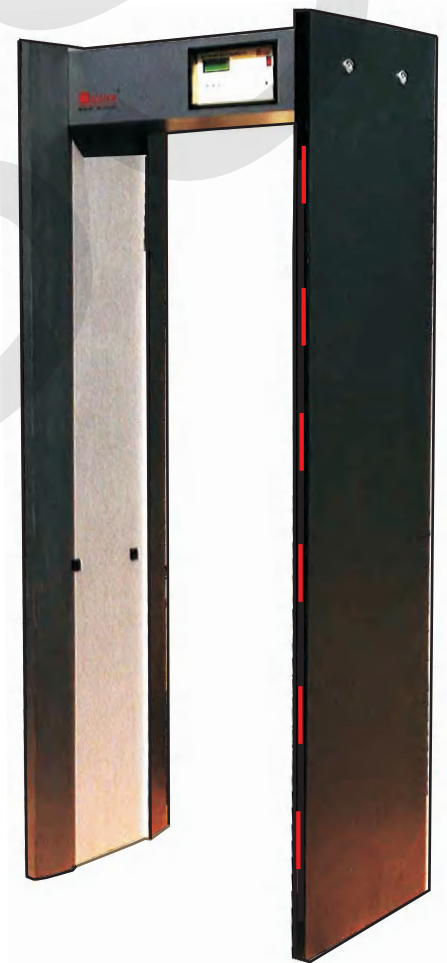

Technical Specifications

- Floor space required : 515 x 895 sq.m (approx)
- Passage Clearance : 515 x 760 x 1865 mm.
- Overall frame assembly : 515 x 895 x 2130 mm.
- Weight : 60 Kg (Approx.)
- Power : 230 VAC \pm 15% 50 Hz, 50 VA

Sensitivity Model RE-MP-VI

- a) Low : Objects like Grenades
- b) Optimum : Small firearms like 22 caliber gun
- c) High : Small Metal Objects of 35 mm side cube of any metal

Other Models : 1) RE-MP-IV (4 zone detection) 2) RE-MP-III (3 zone detection)

TO KEEP PACE WITH LATEST TECHNOLOGY, "RK SECURITY SOLUTION " RESERVES THE RIGHT TO UPDATE THE SYSTEM. HENCE SPECIFICATION ARE SUBJECT TO CHANGE



RK SECURITY SOLUTION

Automatic Vehicle Identification System

What is Automatic Vehicle Identification System?

The automatic vehicle tracking or identification facility delivers the flexibility, scalability, and responsiveness that today's organizations need. It provides accurate, up-to-minute information, high-speed communication, and powerful analysis features required to make better decisions faster. The major potential comes from the much acclaimed no line of sight and simultaneous reading properties of RFID. It is now widely recognized that real-time vehicle information will revolutionize the control and logistical organization with significant vehicle fleets. In a global marketplace where productivity is crucial to success, vehicle fleet operators use vehicle management systems as a formidable tool to drive down costs and increase the value of their service.

Why Automatic Vehicle Identification System?

Being in the manufacturing and transportation business, availability of vehicles and operational efficiency are crucial areas. Due to manual processes, the companies are finding it difficult to determine the exact cycle for a vehicle carrying goods from the factory to a particular destination and carrying raw material as a return load back to the factory. With a mission to improve operational efficiency in terms of cycle-time monitoring and fleet management, the companies are ready to adopt technologies that take care of vehicle tracking.

Also, earlier, no knowledge of status of the consignment was available, which was leading to deviations in vehicle requirement planning. The Key issues in the current scenario are

- Higher error possibilities
- Permit slip is not identified with the vehicle's Identity
- Higher measured weight than actual Possibility of double weighing
- Possibility of two admission/ permit numbers
- Manual entry leads to higher
- possibility of human error

Functional details:

Manual check-in processes can cause errors and delay in accounting for vehicles, especially during peak times when vehicle backlogs often occur. Some vehicles might be missed altogether and vehicle or driver IDs can be logged in error.

To automate the vehicle moment in we need to install Long Range RFID readers in entrance exit locations These readers are connected by internal LAN and are connected with central server. Our offered solution identifies the vehicles at all entry & exit points. The RFID tags are issued permanently to the vehicle.

Automatic Vehicle Identification System

During the entry exit process the vehicle movement will be identified and any deviation the same will be flashed to the control room through dashboard that can be generated as reports. To make the process easy issue passes for monthly, half yearly and yearly basis.



Tag Issuing :

Long-range RFID based Vehicle Tags & personal Tags are issued to all the vehicles entering the plant. This is done at specified entry gates by the security personnel using the tag issue application running on the desktop computer.

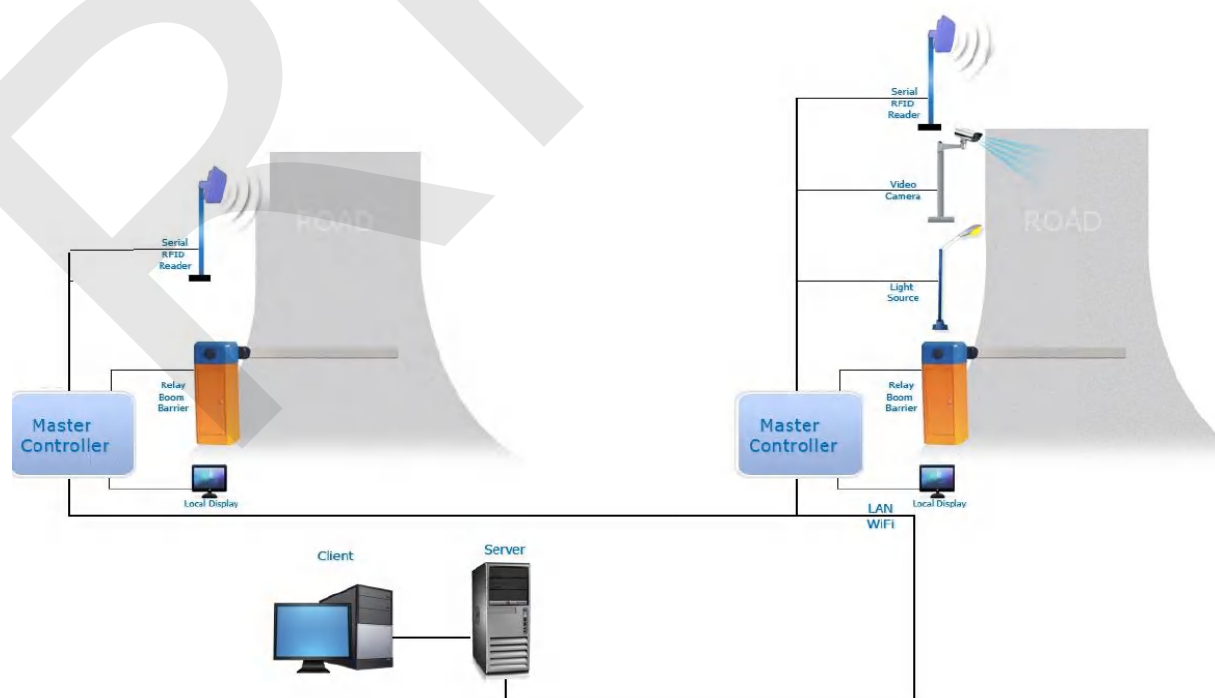
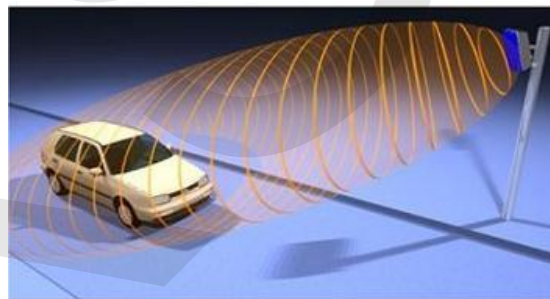

Features of Automatic Vehicle Identification System

Radio Frequency Identification (RFID) devices consist of tags and readers that assist in the tracking of goods and vehicles. Tags are the devices that give identity to the vehicle and work like a wireless name plate. It transmits its identity to readers which are placed at strategic locations like entry/exit of a premise, highway, weighing bridge, parking lots and others. Readers pick up these signals and transmit them to the centralized data servers from where the information can be viewed or utilized anywhere. These readers can also trigger the other peripheral devices like an access control mechanism- boom barrier to operate as per the business logic. For. e.g on identifying a known vehicle, a reader can signal the boom barrier to open and allow the vehicle automatically. The read-range of the reader varies from 1m to 30 m depending upon the technology (Passive Vs Active) in place.

The use of RFID technology also necessitates the purchase and utilization of either fixed or hand held readers which can help the guard to quickly access the vehicle information by bringing the device near the vehicle.

Benefits of Automatic Vehicle Identification System

- 1. Tracking vehicles within the plant:** The use of RFID in a vehicle assembly line ensures optimum operation, enhanced efficiency and eliminates the possibility of fraud and theft. Strategically positioned fixed RFID readers with multiple tags reading capability trace the newly finished cars as they leave the product line. In this way vehicles can be tracked throughout the plant.
- 2. Prevents manipulation of data:** The security issues RFID tags to the trucks that are coming inside the premises. It is attached to the truck that carries the cane load and identification is done throughout its journey.
- 3. Better Fleet Management:** RFID has enabled better fleet management. Now the transporters have a fix on reasons behind vehicular downtime. They know how long it takes to load raw materials and they can measure the performance of drivers. Transporters can plan availability of trucks based on the latest tracking data and make optimum use of their fleets.
- 4. Parking Lot Access Control:** We also provide parking barrier drop-arm control systems to control authorized access into and out of the parking area. RFID based access control systems ensures that only authorized vehicles can get into and get out of the parking area. Parking barrier arms automatically lifts to let the vehicle pass through on successful identification of the vehicle RFID tag.



TWIN PARKING SYSTEM

Key advantages -

- Simple operation
- Easy maintenance
- Low power consumption
- Ideal for bungalows and apartment owners
- All systems operate individually

Specification

Suitable Car	<ul style="list-style-type: none"> • Length (mm) : 5050 • Width (mm) : 2000/2100/2300 • Height (mm) : 1700 - SEDAN* • Height (mm) : 2050 - SUV* • Lifting Capacity (kgs) 2200
Motor	• Geared Break Motor 1.5 kw
Travel Speed	• 3m/min
Power Source	<ul style="list-style-type: none"> • Main - AC 415V, 3 PH, 50 Hz • Lighting - AC 220V, 1 PH, 50 Hz
Operation	• Push Button Control with Safety Locking
Safety	<ul style="list-style-type: none"> • Pallet Stopper/Anti-Fall • Safety Sensors • Emergency Stop • Cam Limit Switch

* Subject to available Clear Heights.



Twin Park • RKSS - 1500

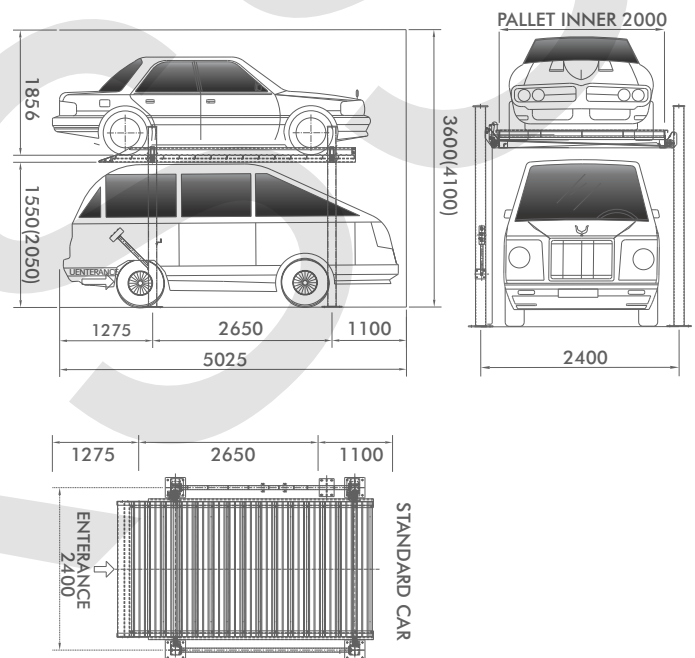

PIT PUZZLE PARKING SYSTEM

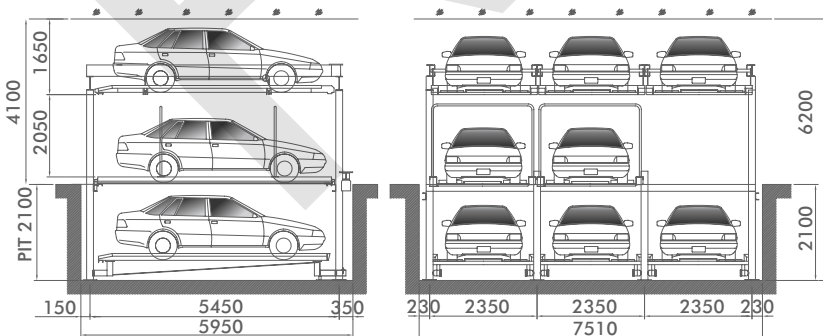

Pit Puzzle • RKSS - Pt 3000

Length (mm)	Width (mm)	Height (mm)	GF. PIT & 2F
5050	2000	2050	1550



HYDRAULIC TYRE KILLER



THE RK-08 MINI HYDRAULIC TYRE KILLER PROVIDES AN ADVANCE OPERATION TO CONTROL ACCESS SMOOTHLY AND EFFECTIVELY BY BASIC OPERATION, AND ALSO PREVENT ILLEGAL IN AND OUT. THE MACHINE IS WELL IN DESIGN, RUSTPROOF, DURABLE AND CAN RESIST EXTERNAL DESTROY. ACCORDING TO DIFFERENT MACHINE CENTERS, INTELLIGENT DRIVE UNIT THROUGH ADVANCED CONTROL UNIT CAN BE DIVIDED INTO FULLY-AUTOMATIC AND SEMI-AUTOMATIC. THEIR DIFFERENCES ARE FULLY AUTOMATIC PRODUCT CAN FINISH ANY WORK BY POWER. THE TYRE KILLER CAN BE OPERATING THROUGH HAND PUMP WHEN IT IS POWERED OFF IF REQUIRED. AND AFTER POWERED UP & SHIFT TO AUTOMATIC MODE AGAIN TYRE KILLER IS READY TO OPERATE.



Specifications

Unit	Single
Drive Unit	Hydro-Static
Power Supply Type	Single Phase / Three Phase 230 VAC / 440 VAC & 50/60 Hz
Electric Motor Capacity	0.85kw to 4.0kw
Protection Class	IP55
Spike Height	150-500mm
Tyre Killer Length	6 meter-8 meter
Wheel Load	60 KN
Impact Load	Appx. 30 KN
Vertical Load	60 KN Vertically (20 T / Axle)
Finish	Galvanized and Plastic Coated 4S – Coating
Surface Protection	Galvanized & Plastic Coated
Operation Time	Raising 1 second & Lowering 1 second
MTBF	1 Million Cycle
Duty Cycle	100%
HYDRAULIC PREAURE	120 BAR
Operating Panel	1.From both side of Mini Tyre Killer through Push Button with key switch control 2.From Remote Control up to 10 meter range
Operating Temperature Range	-5° C to +65° C
Power Failure/Emergency Operation	1.By hand through hand-pump 2.By U.P.S. Power for uninterrupted 2 operations-Up-Down
Electric Controls, Inside Outdoor Enclosure	Steel or Glass fiber reinforced cabinet
Material of Construction	Carbon steel with powder coated finish or stainless steel in Grade 4 finish
Integration	Capable of Integration with the overall architecture of Surveillance & Access Control System
Available Color	Yellow-Black, Red-White

Extra Features (Optional):

1. Traffic Lamp Red / Green / Yellow on a Post and a Warning Lamp with Siren 120Db.
2. Integration with Long Range R.F.I.D. System for Vehicular Management and Access Control.
3. Integration with Daily Operation Log Report Software for better handling.
4. Optional Manual Operation Control Panel as required.
5. Integration with ALPR & UVSS System for extra security feature.

APPLICATIONS:

- † OFFICE BUILDING
- † GOVERNMENT
- † AIRPORTS
- † HOTEL
- † DEFENCE
- † BANK
- † TOLL PLAZA

*Specifications are subject to change without notice.



RKSS10S Series

RKSS10S Single-lane Swing Barrier Turnstile

RKSS11S Single-lane Swing Barrier Turnstile
(w/ controller and RFID reader)

RKSS22S Single-lane Swing Barrier Turnstile
(w/ controller and combination fingerprint and RFID reader)

The RKSS10S single lane swing barrier turnstile is a compact and elegant cost-effective entrance control system designed for customers needing a wide lane.

RKSS10S is a single lane swing barrier turnstile series designed for smooth and silent operation and draws very little power. It's made of stainless steel which makes RKSS10S highly durable. RKSS10S is designed to restrict access to areas for which handicap access (ADA) is required.

The RKSS10S tempered-glass barrier is normally held in a locked position, thus denying passage to the secured side. Upon the RKSS10S reader (RFID and/or fingerprint) positively recognizing a user's valid access card or fingerprint, its barrier swings open automatically, thus allowing users passage to the secured side.

RKSS10S standard configuration ships with a tempered glass barrier. However, the option for a stainless steel bar as a barrier is also available.

RKSS10S provides both **security** and **convenience** for all customers requiring a wider lane than which traditional turnstiles normally provide.

Built-in Reader Integration

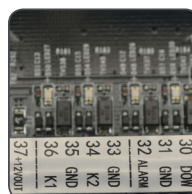

- RKSS10S series ships already integrated with our customers' preference for either a card or fingerprint access control reader. This greatly reduces installation time & expense.
- RKSS10S series and associated access control readers are all factory-tested prior to shipping.
- RKSS provides true plug 'n play turnstiles with the lowest possible total cost of ownership in the industry!

Specifications

Power Supply	AC110V/ 220V, 50/ 60Hz
Power Consumption	16W (Starting), 9W (Standby), 30W (Unlock)
Operating Temperature	-18°F to 140°F (-28°C to 60°C)
Operating Humidity	5%-80%
Working Environment	Indoor/Outdoor (if sheltered)
Traffic Throughput	10 passages per minute
Casework Material and Barrier Material	SUS304 Stainless Steel
Visual Indicator	Yes
Emergency Button Input	Yes
Barrier Movement	Swing
Gate Dimension	40 (l) x 8 (w) x 43 (h) inches (1030 (l) x 210 (w) x 1100 (h) mm)
Lane width	3 feet (900 mm)
Footprint	40 x 8 inches (1030 x 210 mm)
Gate Weight	68 lbs (31 kg)

Dimensions

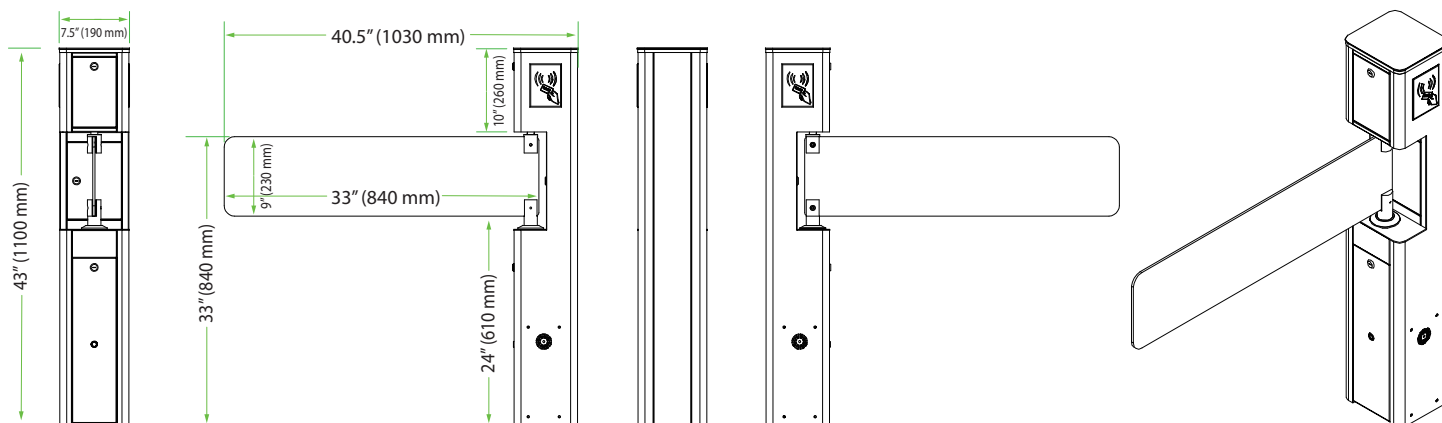



RK SECURITY SOLUTION

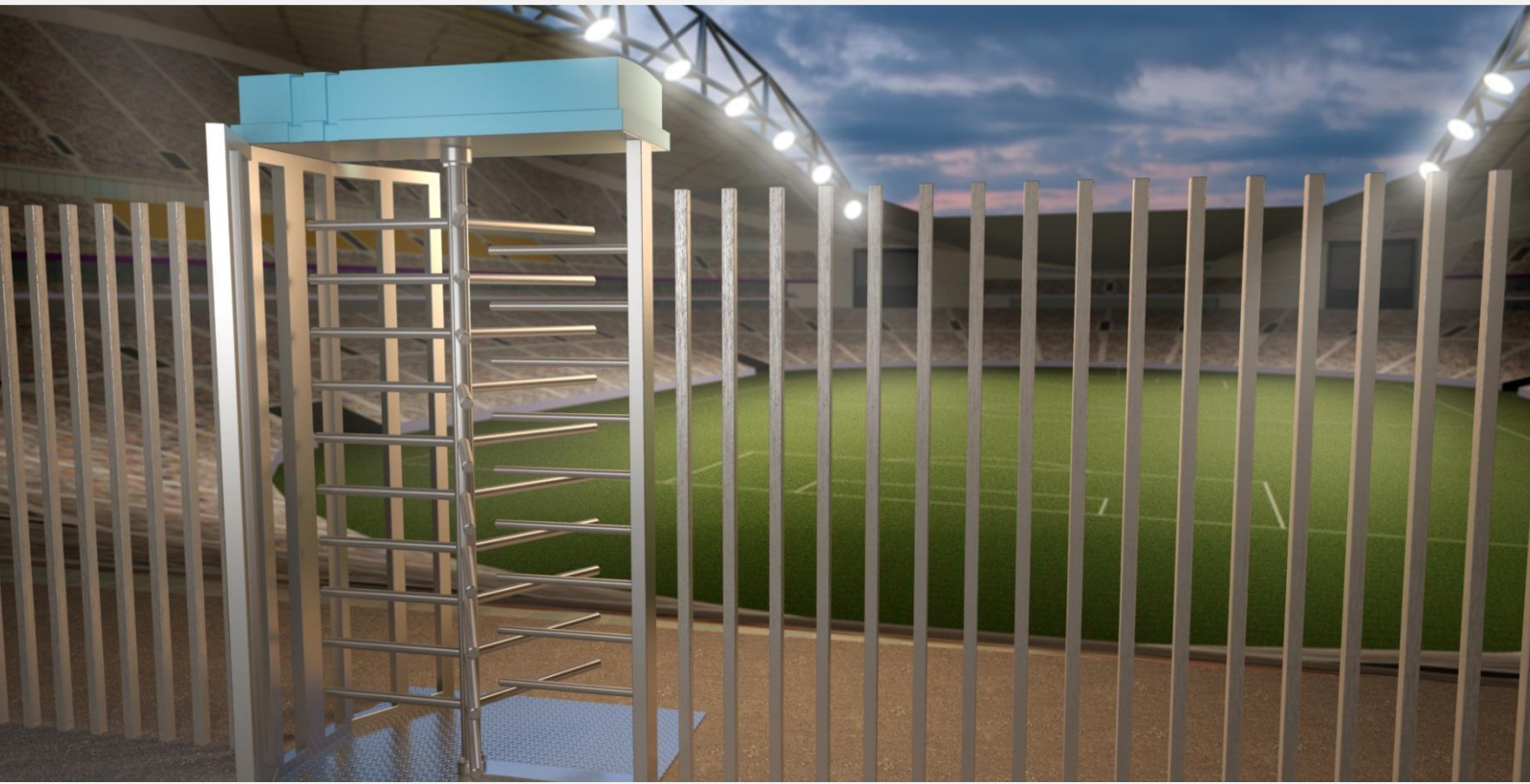

Full-height
Turnstile Gates